

求積表

地番	1 261-1			
NO	Xn	Yn	Yn+1-Yn-1	Xn · (Yn+1-Yn-1)
P5	132.986	135.614	12.261	1630.541346
C2	134.241	134.601	-8.300	-1114.200300
C1	142.961	127.314	-12.923	-1847.485003
K5	149.554	121.678	-7.648	-1143.788992
K4	149.260	119.666	-10.229	-1526.780540
K2	138.375	111.449	-9.085	-1257.136875
P1	127.409	110.581	0.037	4.714133
P2	126.594	111.486	12.103	1532.167182
P3	128.667	122.684	10.854	1396.551618
P4	130.529	122.340	12.930	1687.739970
合計				-637.677461
合計面積				318.8387305
地積				318.83 m ²

地番	2 261-5			
NO	Xn	Yn	Yn+1-Yn-1	Xn · (Yn+1-Yn-1)
P10	120.995	145.006	19.629	2375.010855
C4	121.756	144.426	-7.057	-859.232092
C3	130.093	137.949	-8.812	-1146.379516
P5	132.986	135.614	-15.609	-2075.778474
P4	130.529	122.340	-12.930	-1687.739970
P3	128.667	122.684	-10.854	-1396.551618
P2	126.594	111.486	-12.103	-1532.167182
P1	127.409	110.581	-1.553	-197.866177
P6	119.223	109.933	0.414	49.358322
P7	120.402	110.995	13.843	1666.724886
P8	122.768	123.776	13.802	1694.443936
P9	117.254	124.797	21.230	2489.302420
合計				-620.874610
合計面積				310.4373050
地積				310.43 m ²

地番	3 261-6			
NO	Xn	Yn	Yn+1-Yn-1	Xn · (Yn+1-Yn-1)
K1	100.621	108.461	7.391	743.689811
C12	102.327	117.324	18.760	1919.654520
P11	104.159	127.221	7.473	778.380207
P9	117.254	124.797	-3.445	-403.940030
P8	122.768	123.776	-13.802	-1694.443936
P7	120.402	110.995	-13.843	-1666.724886
P6	119.223	109.933	-2.534	-302.111082
合計				-625.495396
合計面積				312.7476980
地積				312.74 m ²

地番	4 261-7			
NO	Xn	Yn	Yn+1-Yn-1	Xn · (Yn+1-Yn-1)
C7	108.949	153.099	26.239	2858.712811
C6	109.884	153.460	-1.390	-152.738760
C5	112.208	151.709	-8.454	-948.606432
P10	120.995	145.006	-26.912	-3256.217440
P9	117.254	124.797	-17.785	-2085.362390
P11	104.159	127.221	28.302	2947.908018
合計				-636.304193
合計面積				318.1520965
地積				318.15 m ²

総合計面積	1260.1758300 m ²
-------	-----------------------------

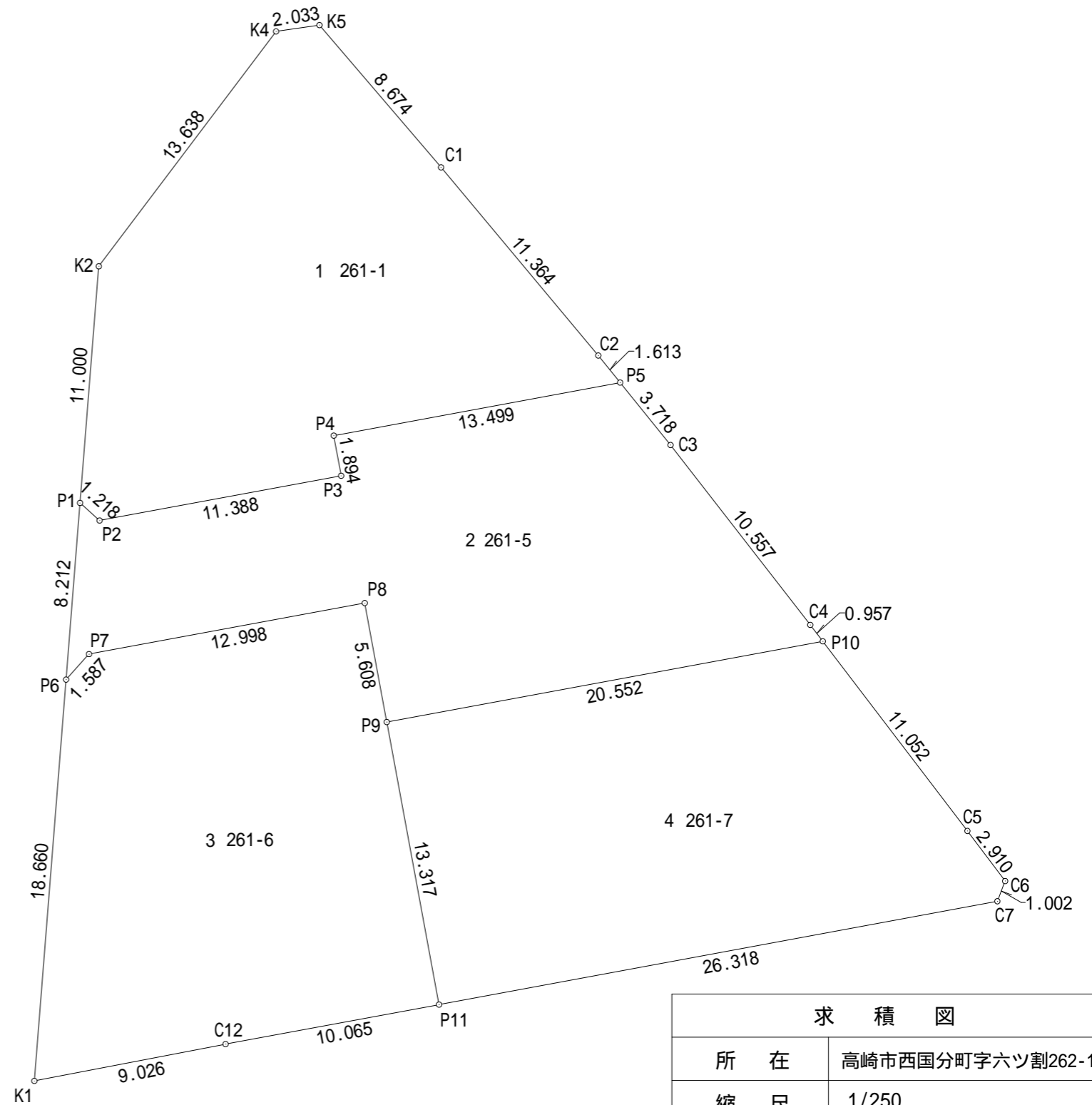

求積図	
所在	高崎市西国分町字六ツ割262-1
縮尺	1/250
作成日	令和3年4月26日
作成者	土地家屋調査士 須長 亮